

# FUEL LINE SYSTEM

## SCHEMATICS AND REFERENCE GUIDE

TYPICAL APPLICATION :  
COMMERCIAL ENGINE INSTALLATIONS 6 L AND LARGER

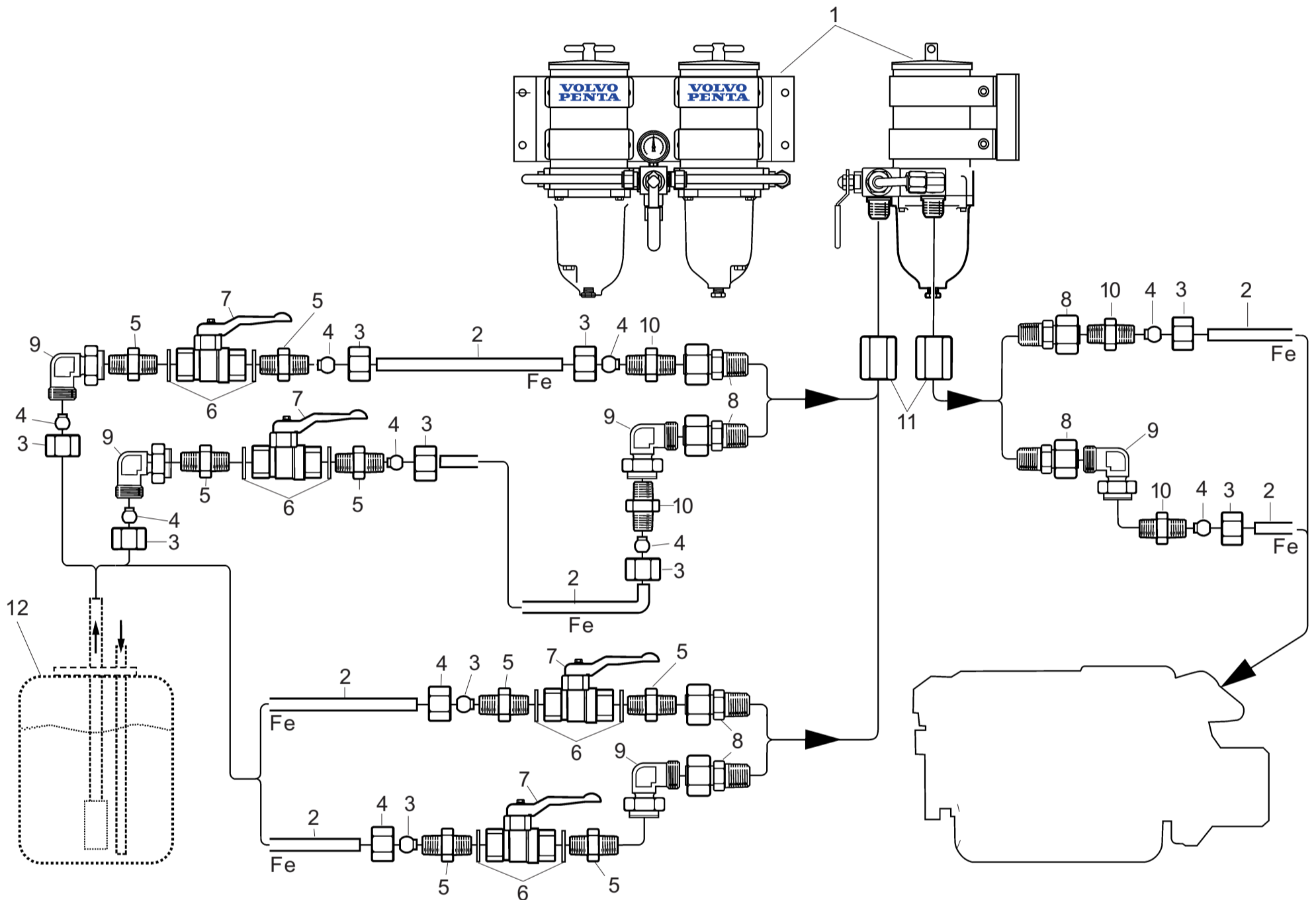

### Partno. / Dimension

	Partno. / Dimension		Filter inserts	
	Ø12 mm	Ø15 mm	10 micron	30 micron
1.	877770, 7/8" Con. 889280, 7/8" Con. 889281, 7/8" Con.	877770, 7/8" Con. 889280, 7/8" Con. 889281, 7/8" Con.	3838852 3838854 3838854	889419 889422 889422
2.	Fe *	Fe *		
3.	956984(M18)	956985(M22)		
4.	980782(Ø12)	956971(Ø15)		
5.	963959(M18-3/8")	943986(M22-1/2")		
6.	947623(Ø17)	947626(Ø21)		
7.	3584415(Ø3/8")	3584416(Ø1/2")		
8.	984388(M18-7/8")	984389(M22-7/8")		
9.	964016(M18-M18)	946369(M22-M22)		
10.	957056(M18-M18)	957057(M22-M22)		
11.	3586248(7/8"-7/8")	3586248(7/8"-7/8")		
12.	*	*		

\* Not stocked by Volvo Penta

Note !  
Volvo Penta 840879 should be used on tapered nipples, please refer to ill.1

Ill. 1

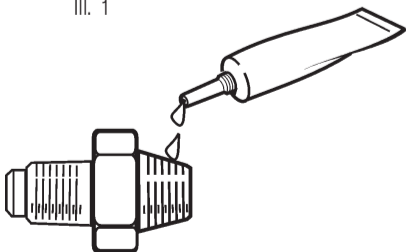

Note !

The non-return (2, ill. 2) valve in the primary fuel filter must be removed when installed together with an electric fuel shut-off valve (1, ill. 2). See respective filters installations manual for further details.

Ill. 2

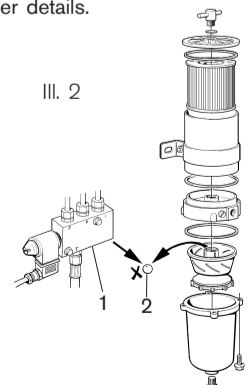

# VOLVO PENTA

Filters 877770 are recommended for engines with a maximum fuel flow of 1363 litres/hour [l/h] or 360 gallons/hour [g/h].

Filters 889280 & 889281 are recommended for engines with a maximum fuel flow of 1363 litres/hour [l/h] or 360 gallons/hour [g/h].

Always refer to your engines technical data concerning maximum fuel flow rate and fuel flow restriction.

There might be requirements for an alternative positioning of one or more of these components, refer to local legislation for advice